

**FLOOR AREA AND BUILDING HEIGHTS**

BUILDING	FLOOR AREA (SF)	HEIGHT (FT)
PREPARATION	110,000	105
EXTRACTION	85,000	120
REFINERY	100,000	150
UTILITIES	30,000	40
DEGUMMING	12,000	40
OFFICE / MAINTENANCE	25,000	30
COLD STORAGE	7,500	25
FIRE PUMP	2,500	20
TRUCK RECEIVING	7,500	30
TRUCK LOADOUT	7,500	80
TRUCK OIL LOADOUT	500	25
WASTE WATER TREATMENT	30,000	40
FLAT STORAGE	175,000	50
HIGHEST STACK	N/A	200

**SURFACE AREAS**

AREA	FOOTAGE (SF)
PROPOSED LOT AREA	13,800,000
IMPERVIOUS SURFACE AREA	1,500,000
TOTAL FLOOR AREA RATIO: 4.2%	
IMPERVIOUS SURFACE RATIO: 10.9%	
LANDSCAPE SURFACE RATIO: 89.1%	

**GENERAL NOTES:**

- ① EXTERIOR LIGHTING DETAILS TO BE DETERMINED. ALL EXTERIOR DOORWAYS SHALL INCLUDE WALL PACK LIGHT. GENERAL PLANT LIGHT LEVEL ASSUMED TO BE 2 FOOT CANDLES. PLANT SHALL BE DESIGNED TO MEET CITY REQUIREMENTS REGARDING DARK SKY COMPLIANCE.

**KEYED NOTES:**

- ① PROPOSED CHS MONUMENT SIGN. DIMENSIONS, TYPE AND LIGHTING TO BE DETERMINED.
- ② PROPOSED CHS LOGO ON TOP OF MEAL STORAGE. DIMENSIONS, TYPE AND LIGHTING TO BE DETERMINED.
- ③ PARKING LOT DIMENSIONS ARE 215'-0" X 158'-0" WITH 60 SPACES AND 4 ADA SPACES.

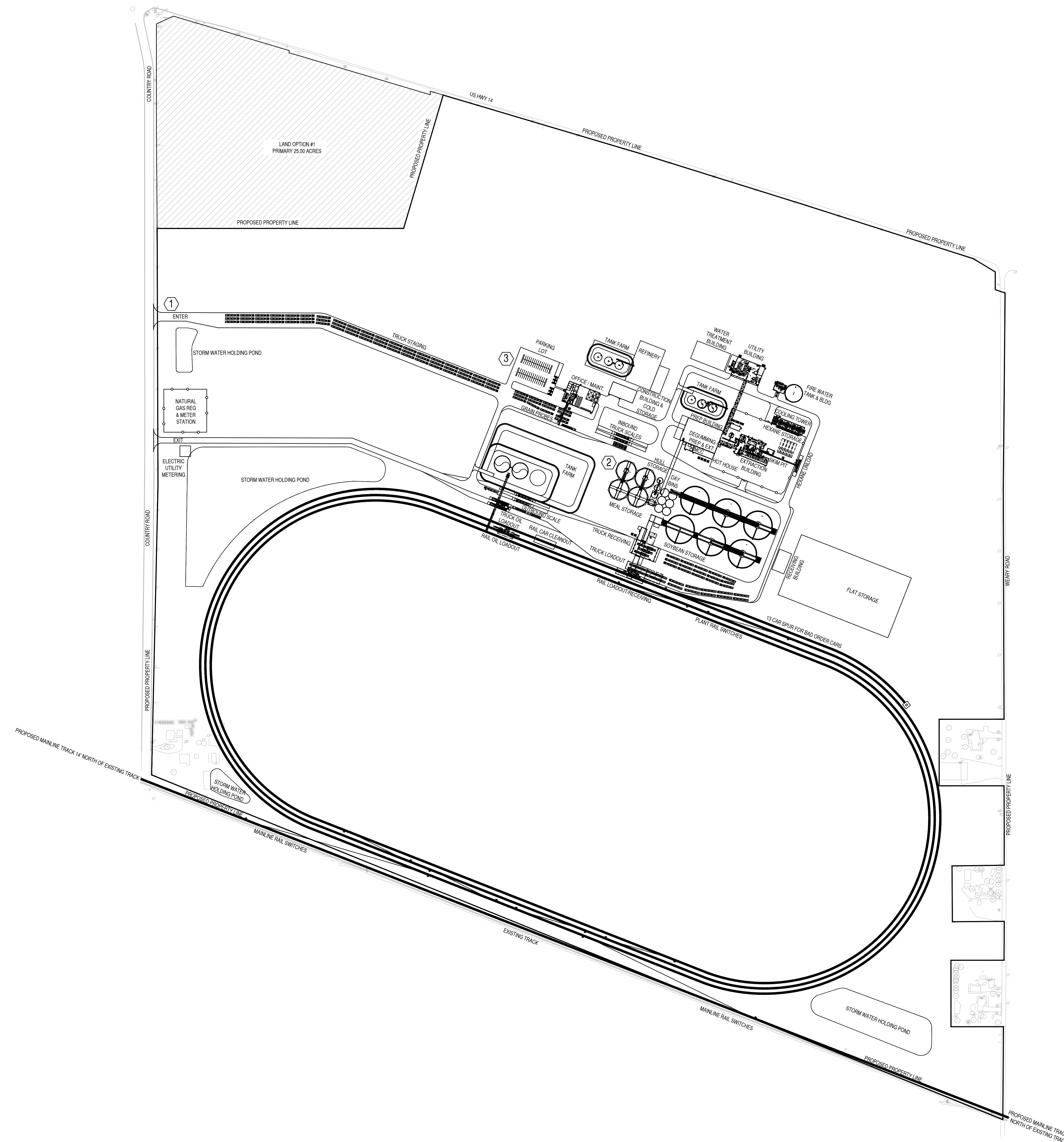

1 CITY APPLICATION SITE PROPERTY PLAN NO IMAGE - TRUE NORTH  
GAR-0002 1"=200'-0"

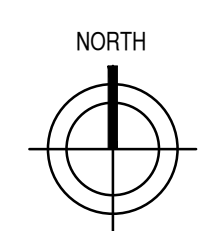

**PRELIMINARY  
NOT FOR CONSTRUCTION**

**CONFIDENTIAL**  
Confidential and Proprietary Information. These documents may not be used or reproduced without the express written consent of KFI Engineers.

**KFI  
ENGINEERS**  
670 County Road B West  
St. Paul, Minnesota 55113  
Tel: (651) 771-0880 Fax: (651) 771-0878  
Email: kfi@kfi-eng.com

THIS DRAWING IS THE PROPERTY OF CHS AND IS SUBJECT TO RETURN ON DEMAND. NO PART OF THE INFORMATION CONTAINED WITHIN THIS DRAWING MAY BE REPRODUCED, STORED IN A RETRIEVAL SYSTEM OR TRANSMITTED IN ANY FORM, ELECTRONIC, MECHANICAL, PHOTOCOPIING, OR OTHERWISE, WITHOUT WRITTEN CONSENT OF:  
  
CHS Oilseed Processing

NO.	DATE	REVISION	BY
A	07/05/23	ISSUED FOR REVIEW	KFI

DESIGNER:	CITY APPLICATION SITE PROPERTY	REVISION NO.:
KFI	PLAN NO IMAGE - TRUE NORTH	A
DRAWN:		DRAWING NAME:
CHECKED:		DEPARTMENT:
KFI		DATE PRINTED:
DRAW DATE:	Oilseed Processing - PROJECT ORANGE	DRAWING NO.:
07/05/23		GAR-0002
SCALE:		
AS NOTED		